

**ON-LOT IMPERVIOUS AREAS**

HOUSE	2042
F PORCH	208
F PATIO	58
R PORCH	133
R STOOP	27
F WALK	139
DRIVE/WALK	192
TTL	2799
ALLOWED	2800

FROM APPROVED CHART:  
118 LF TRENCH REQUIRED

GARY W. KEYES LAND SURVEYING, P.C. FIRM# C-4086  
PO BOX 1624 WRIGHTSVILLE BEACH, NC 28480  
910-228-4773 keyessurveying@gmail.com

I, Gary W. Keyes, certify that this plat was drawn under my supervision from an actual survey made under my supervision or from deed description recorded in Book \_\_\_\_\_, Page \_\_\_\_\_; that the boundaries not surveyed are shown as broken lines plotted from Book \_\_\_\_\_, Page \_\_\_\_\_ or other source as noted; that the closure error as calculated by lat. and dep. is  $1/10,000$ .

Witness \_\_\_\_\_ Signature, PLS #, and seal this 13th day of JUNE, A.D. 20 18.

Land Surveyor: **GARY W. KEYES**, L-4381  
PLS # \_\_\_\_\_

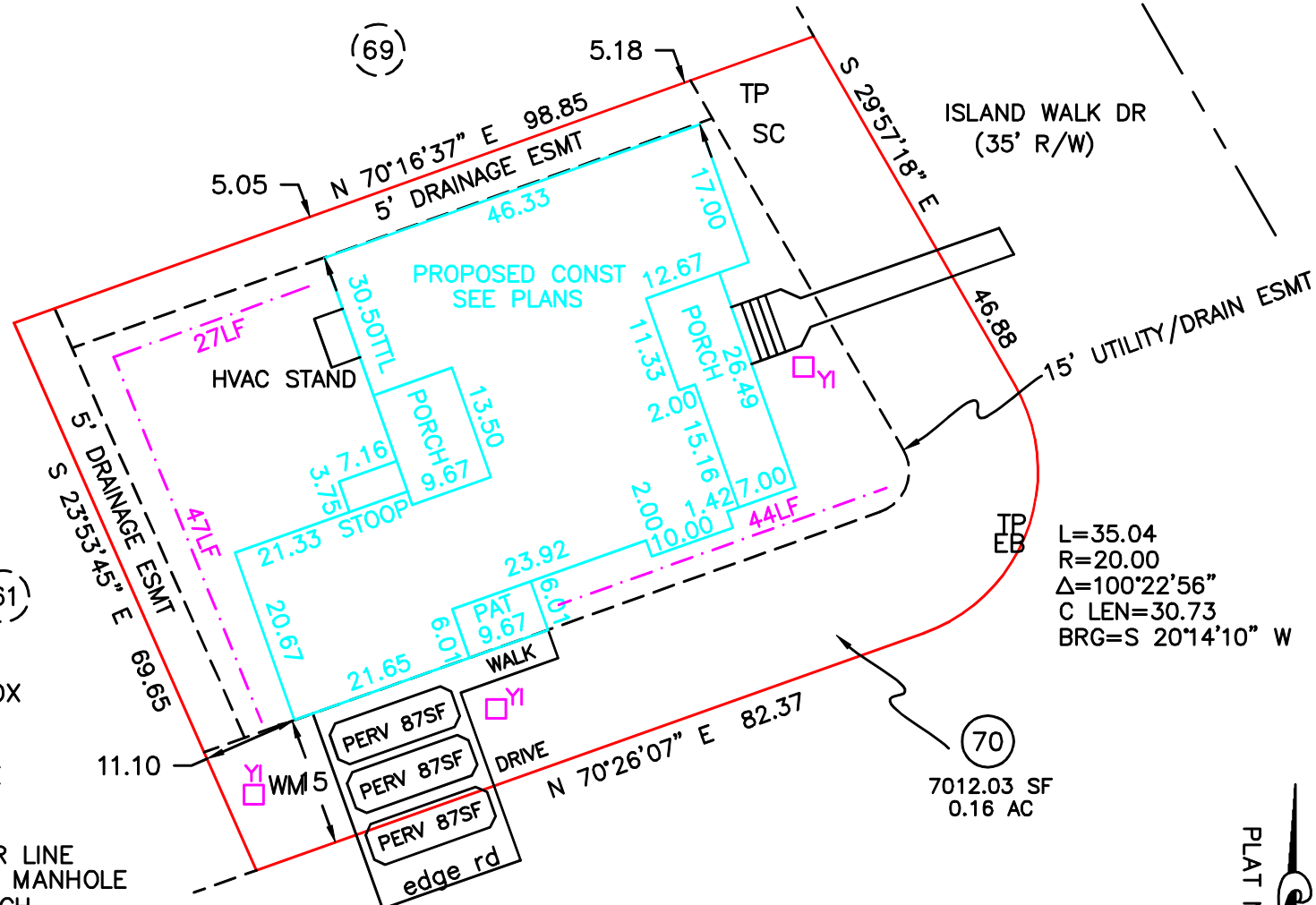

- LEGEND:**  
 HB = HOTBOX  
 WM = WATER METER  
 EB = ELECTRICAL BOX  
 MB = ELECTRIC METER BOX  
 SC = SEWER CLEANOUT  
 G = GUY WIRE  
 EIP = EXISTING IRON PIPE  
 ERB = EXISTING REBAR  
 RBS = REBAR SET  
 OHPL = OVERHEAD POWER LINE  
 SSMH = SANITARY SEWER MANHOLE  
 SCP = SCREENED-IN PORCH  
 PAT = PATIO  
 YI = YARD INLET PROPOSED (ADJUST AS NEC FOR TOPOGRAPHY)

----- TRENCH LINE (PRE-APPROVED SPEC 100 LF MIN)  
 (SEE SPEC/DESIGN OF TRENCH SYSTEM BY OTHERS)  
 4LF TRENCH PER 100 SF IMPERVIOUS REQUIRED PER STORMWATER PERMIT

AREA BY COORDINATE METHOD



THIS PROPERTY LIES IN ZONE X  
 AS SHOWN ON FEMA FIRM BY GRAPHIC  
 FIRM MAP# 3720108600J  
 EFFECTIVE JUNE 2, 2006

SETBACKS:  
 15' FRONT  
 5' SIDE  
 9' REAR

PRELIMINARY SITE PLAN  
 LOT 70  
 TIDDEWATER AT OCEAN ISLE

(City Map Not to Scale)

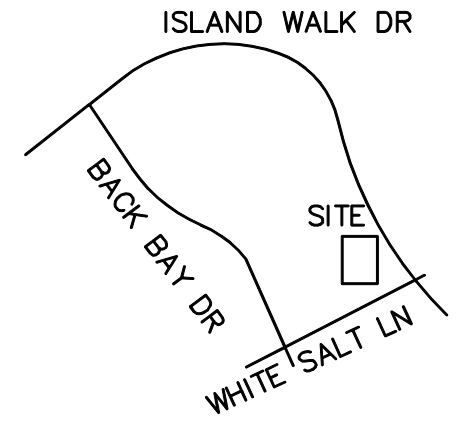

TOWNSHIP SHALLOTTE		
COUNTY	BRUNSWICK	STATE NC
DATE	06/22/18	SCALE 1"=20'

OWNER:  
 COTTAGES AT TIDEWATER, LLC  
 22549 NC HWY 210  
 ROCKY POINT, NC 28457  
 PARCEL 244CD070  
 4783 ISLAND WALK

PLAT NORTH MC 47 PG 1